

# Explozie piese de schimb BTA-ST400 Freza de zapada

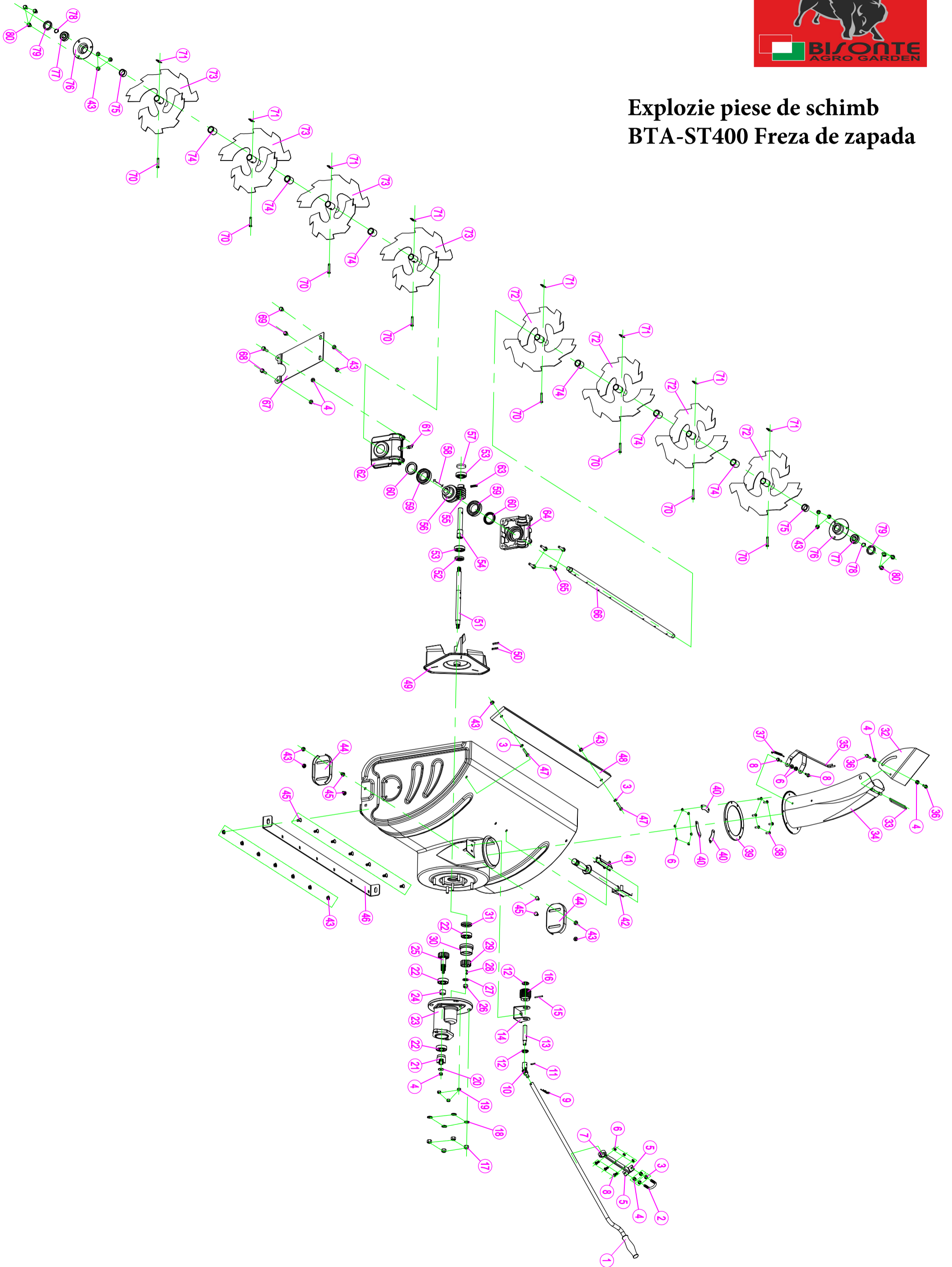



1		ST400-01	1	201859001	1
2	Q235-A	ST400-02	1	201859002	2
3	D8	GB/T95-2002	4	G02003B	3
4	M8	GB/T889.1-2000	7	G04005B	4
5	Q235-A	ST400-03	2	201859003	5
6	M6	GB/T889.1-2000	11	G04006B	6
7	PA6-GF30	ST400-04	1	201859004	7
8	M6×16	GB/T5789-1986	5	G01435B	8
9	65Mn	ST400-05	1	201859005	9
10	Q235-A	ST400-06	1	201859006	10
11	D4×20	GB/T879.1-2000	1	G11001	11
12	45#	ST360-16	2	201859007	12
13	45#	ST400-07	1	201859008	13
14	Q235-A	ST360-100	1	201859009	14
15	D4×35	GB/T879.1-2000	1	G11002	15
16	45#	ST400-08	1	201859010	16
17	M10	GB/T889.1-2000	4	G04004B	17
18	D10	GB/T95-2002	4	G02002B	18
19	M8	GB/T6172.1-2000	3	G04015B	19
20	D24×d8.5×2	GB/T96.2-2002	1	G02006B	20
21	20CrMnTi	ST400-09	1	201859011	21
22	D47×d20×14	GB/T276-1994	3	G08038	22
23	HT250	ST400-10	1	201859012	23
24	Q235-A	ST400-11	1	201859013	24
25	20CrMnTi	ST400-12	1	201859014	25
26	M12	GB/T889.1-2000	1	G04016B	26
27	D12	GB/T95-2002	1	G02001B	27
28	5×5×16	GB/T1096-2003	1	G07033	28
29	20CrMnTi	ST400-13	1	201859015	29
30	Q235-A	ST400-14	1	201859016	30
31	D47×d20×7	GB/T9877.1-1988	1	G05058	31
32	Q235-A	ST400-15	1	201859017	32
33	Q235-A	ST400-16	1	201859018	33
34	Q235-A	ST400-17	1	201859019	34
35	Q235-A	ST400-18	1	201859020	35
36	M8×14	GB/T70.2-2008	2	G01470B	36
37	65Mn	ST400-19	1	201859021	37
38	M6×20	GB/T5789-1986	6	G01440B	38
39	PA6-GF30	ST400-20	1	201859022	39
40	Q235-A	ST400-21	3	201859023	40
41	PA6-GF30	ST400-22	1	201859024	41
42		ST400-23	1	201859025	42
43	M8	GB/T6183.1-2000	21	G04018B	43



44	Q235-A	ST400-24	2	201859026	44
45	M8×20	GB/T12-1988	11	G01094H	45
46	Q235-A	ST400-25	1	201859027	46
47	M8×35	GB/T5782-2000	2	G01047H	47
48	Q235-A	ST400-26	1	201859028	48
49	Q235-A	ST400-27	1	201859029	49
50	D6×36	GB/T879.1-2000	2	G11005	50
51	Q235-A	ST400-28	1	201859030	51
52	D40×d25×7	GB/T9877.1-1988	1	G05021	52
53	D47×d20×15.25	GB/T297-1994	2	G08028	53
54	40Cr	ST400-29	1	201859031	54
55	40Cr	ST400-30	1	201859032	55
56	铜合金	ST400-31	1	201859033	56
57	45#	ST400-32	1	201859034	57
58	8×7×80	GB/T1096-2003	1	G07034	58
59	D68×d40×15	GB/T276-1994	2	G08135	59
60	D55×d40×7	GB/T9877.1-1988	2	G05059	60
61		ST400-33	1	201859035	61
62	ADC12	ST400-34	1	201859036	62
63	D8×30	GB/T879.1-2000	2	G11025	63
64	ADC12	ST400-35	1	201859037	64
65	M8×40	GB/T5789-1986	4	G01455B	65
66	40Cr	ST400-36	1	201859038	66
67	Q235-A	ST400-37	1	201859039	67
68	M8×35	GB/T5789-1986	2	G01429B	68
69	M8×20	GB/T5789-1986	2	G01059H	69
70	Q235-A	ST400-38	8	201859040	70
71	65Mn	ST400-39	8	201859041	71
72	Q235-A	ST400-40	4	201859042	72
73	Q235-A	ST400-41	4	201859043	73
74	PA6-GF30	ST400-42	6	201859044	74
75	PA6-GF30	ST400-43	2	201859045	75
76	Q235-A	ST400-44	2	201859046	76
77	D40×d17×12	GB/T276-1994	2	G08108	77
78	D17×1	GB/T894.1-1986	2	G09027	78
79	Q235-A	ST400-45	2	201859047	79
80	M8×16	GB/T5789-1986	2	G01058H	80